

July 19, 2024 by [Isabelle Lomholt](#)

Sofie Haug Children's Day-Care Centre Tübingen, Modern Baden-Württemberg building, southwest German Architecture images

Sofie Haug Children's Day-Care Centre in Tübingen

9 July 2024

Design: Dannien Roller Architekten + Partner

Location: Tübingen, Baden-Württemberg, southwest Germany



Photos by Dietmar Strauss, Besigheim



Sofie Haug Children's Day-Care Centre, Germany

Designed by Dannien Roller Architekten + Partner for the city of Tübingen, the **Sofie Haug** opened on the city's Rosenauer Weg in 2022.



With a walkout basement set into a slope, the two-storey hybrid-timber building forms an architectural focal point which pays almost perfect homage to the ambitiously modelled terrain, while ensuring the mature tree population is retained. The building's rotation creates a forecourt as a transition area leading to the day-care centre's protected grounds.



The rear-ventilated façade of charred spruce, interacting with bright, glazed teal spruce to form a rhythmic pattern, achieves an enchantingly mystic effect, arousing curiosity not only in children. Elemental and earthbound in its consolidation of the special charms its surroundings offer, this woodland sanctum invites visitors to explore its mystery via the glazed main entrance. Set at an angle within the façade, it is framed by glazed spruce with a highly intense teal colour that evokes mountain and forest lakes.



- The southern garden side featuring the group rooms includes an access balcony structure, which contrasts with the predominantly enclosed north side. This creates a distinctive grid in front of the façade with floor-to-ceiling openings. Dark steel columns resemble a second skin, owing to their filigree grouping. The zone between the building and the outside world provides a space for both privacy and social interaction. When the sun shade is extended, two hot-dip galvanised steel staircases lead to the open air in the varied play and activity area in the garden.



The interaction between traditional wood and cool steel produces a dynamism, rooted in the idea that the day-care centre is designed to be an inspiring workshop for children's creativity.

Palma de Mallorca
ab 42,49 €
Jetzt buchen



The east side is charged with tension with its glazed walkout basement nestled in the hillside. The building rises above the slope, seemingly weightless. Reflections in the glass and the supporting structure, showing through like a stylised root system, allow architecture and nature to interconnect.



The building's spatial layout is well-defined and uncluttered, adapted to the children's need for structure. A wide central corridor provides access on both the ground and upper floors. The north side houses the service rooms, as well as the staircase and exposed concrete lift shaft in the centre, while the recreation rooms are located to the south with direct access to the outside.



The centre's management office and the kitchen are positioned next to the multifunctional foyer. The crèche rooms are located in the building's eastern section.



The forest and nature theme continues inside. The complex communication system between materials and colours resembles a bright forest clearing. Walls of light-coloured spruce seem to grow out of the dark-brown, structured, earthy rubber floor. The ceilings, covered with light blue wood wool panels, bring the sky into the building's rooms. The radiant sulphur-yellow paint on the oak doors symbolizes the sun and wild forest flowers.



Interlacing of materials in the staircase, where the grey exposed concrete of the lift shaft meets light spruce wood and raw black steel, creates a composition full of tension. Complex colours, shapes, and structures encourage children's enjoyment of visual and haptic perceptions. Large glazed surfaces and floor-to-ceiling windows with embedded seats bring nature into the rooms and invite children to linger.





The interior and exterior seem to melt into one another in the walkout basement. The exposed concrete walls, implanted into the slope, enfold the movement space. This dialogue, and the polarity of materials, results in an atmospheric spatial experience. Modern aesthetic design language, combined with natural materials and dominant colour contrasts, creates an imaginative venue that fulfils children's desire for narrative architecture.

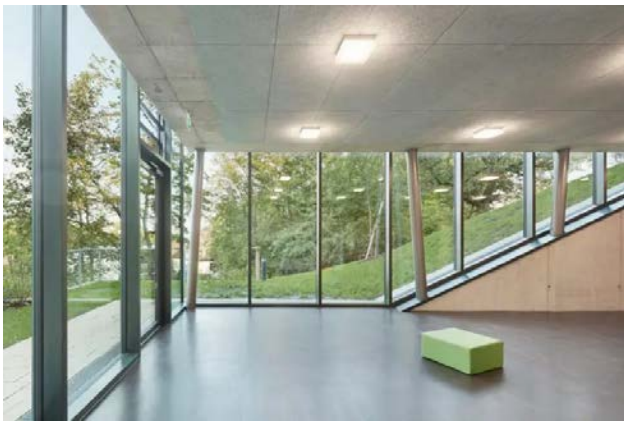

Sofie Haug Children's Day-Care Centre in Tübingen, Germany – Building Information

Architects: Dannien Roller Architekten + Partner – <https://dy-architekten.de/projekte/>

Specialist planners

Static: merz kley partner ZT GmbH, Dornbirn-A

Landscape Architecture: Dagmar Hedder, Tübingen

HVAC, Construction physics: Ebök, Planung und Entwicklung GmbH, Tübingen

Electric: IB Raible, Reutlingen

Survey: Ingenieurbüro Helle, Tübingen

Soil Surveyor: Berghof Analytik + Umweltengineering GmbH, Tübingen

Safety Coordinator: Ing. Büro für Baukoordination Angelika Baur, München

Executing companies

Shell construction: Gottlob Brodbeck GmbH & Co. KG, Metzingen

Drywall construction: Ullrich & Schön GmbH, Fellbach

Woodwork: TragWerk GmbH, Eutingen im Gäu

Roof Installation: H. Fritz GmbH, Sulz am Neckar

Locksmith: Georg Holder GmbH, Reutlingen

Paintwork: Malerwerkstätten Post GmbH, Tübingen

Flooring: Hagenlocher Raumausrüstung GmbH, Magstadt

Screed Work: Estrich Benirschke e.K., Göppingen

Facade: Zimmerei Hämmerle, Tübingen

Electrical Work: Elektro Schmid GmbH, Tübingen

Scaffolding: Quadrex, Ammerbuch

HVAC: Ulrich Schmid Sanitär, Baiersbronn

Windows: Schreinerei Peter Knupfer, Dendingen

Doors: Schreinerei Klink, Tübingen

⚙ Cabinetmake: Bühler Einrichtungen, Ammerbuch

Kitchen planning: Geisel GmbH Großküchenplanung, Reutlingen

Solar protection: Hoefgen Sonnen- und Blendschutz, Steinenbronn

PV-System: Galicium Solar GmbH, Tübingen

Play equipment: Ziegler Spielgeräte von A bis Z, Zeitlitz

Lock System: Müller Sicherheitstechnik, Mössingen



Products

Rubber: Artigo Kayar K102 dark brown; Fa. Objektflor

Acoustic ceiling: Heradesign fine, light blue NCS S 2010-B30G; Fa. Heradesign

Tile wall: Vitra white 5×5 and 20×20; Fa. Vitra (Kitchen)

Tile floor: Neutro Tortura 60×60, Fa. Matarazzi

Doors: Fa. Schörghuber

Door hinges: concealed, Fa. Tectus

Door handle: FSB 1268 bronze outside, stainless steel inside Fa. FSB

Integrated door closer: Dormakaba ITS 96

Elevator/lift: ISI 2040 – 630kg; Fa. Schmitt & Sohn

Window handles: FSB 1268 Steel rounded rosette, Fa. FSB

Curtain: Trevira CS Shade dense 503 hellgrau, Fa. Creation Baumann

Solar protection: Awning with easy-zip-Control Screen 3532 RAL 9004 schwarz; Fa. Warema

Toilet-partition wall: Kindergarten facility SVF30, Partition walls SVFG 40; Fa. Schäfer Trennwandsysteme

Toilet: Geberit Bambini, Fa. Geberit

Washbasin: Varicor Wash trough; Fa. Schüske

Flush toilet Robin Levien; Fa. Connect

Mixing tap WC: Talis M25; Fa. Grohe

Built-in furniture: Surfaces HPL V10410MP; Fa. Pfeleiderer

Built-in sink: Solis 500 FF/A, Fa. Blanco

Lighting fixture: Catania 4050 (light channel); Fa. Barthelme

Wall lighting fixture: SKEO PURA 26; Fa. Trilux

Lighting fixture: LED CIRCLE Downlight; Fa. Dotlux

Brig 02 Anba

u downlight; Fa. Dotlux

Switch system: AS 500, Fa. Jung



About Dannien Roller Architekten + Partner

Dannien Roller Architekten + Partner is an architectural office with many years of continuity, operating in Germany's Baden-Württemberg region, with the office based in Tübingen. The development and reworking of buildings for science, research, municipalities, industry, business, and social institutions, as well as new constructions, conversions, and monument conservation, are the firm's main focus. They design and plan buildings, interiors, renovations, monuments, feasibility studies, target planning, urban development studies, and infrastructure measures. They also supervise construction sites during ongoing operations.



The Dannien Roller Architekten + Partner office is managed by Maren Dannien and Matthias Roller. Together with a highly qualified and motivated team, all challenges are solved creatively, innovatively, and efficiently. Specialist knowledge, experience, and regular training complement the firm's innovative creativity and exceptional design quality.